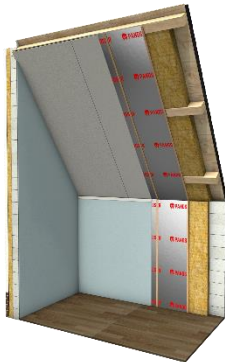

PANDSER® TOP

Construction membrane
for installation on
the warm side.

GENERAL

Pandser® Top is a vapour-barrier and airtight multilayer LDPE-foil, reinforced with fibres. The transparent color of this membrane makes installation easier. Pandser® Top complies with the European standard EN 13984, type A

Pandser® Top is available in the following dimensions:

Dimensions	Article number	EAN-code
1,50 x 25 meters	DWF10150-0009	8713331013596
1,50 x 50 meters	DWF10150-0010	8713331351377
2,00 x 50 meters	DWF10150-0011	8713331351391
2,60 x 50 meters	DWF10150-0012	8713331352282

APPLICATION

Pandser® Top is used as a vapor barrier on the warm side in roof and facade constructions in new buildings and in renovation projects for constructions belonging to climate class 2 and 3 (homes, offices, etc.). For climate class 4 it is recommended to use a vapour-tight membrane (Pandser® Top Alu or Pandser® Aluflex). The reinforcement prevents potential damage to the airtightness. For very high mechanical purposes, this product is also available in a heavier version (Pandser® Top XS). The membrane is also suitable as temporary glazing.

PRODUCTPROPERTIES

Roof



Foundation



Facade



Hard surface



Soft surface



Waterproof



Vapour barrier

Essential characteristics	
Mass per unit area	90 gr/m ²
Reaction to fire	F
Water tightness	Conforming
Water vapour transmission properties (Sd)	35 [m] (-10/+10)
Determination of resistance to impact	NPD (no performance determined)
Joint strength	NPD (no performance determined)
Maximum tensile force (MD/CMD)	>210 / >190 [N/50mm]
Resistance to tearing (MD/CMD)	>135 / >125 [N]
Resistance to alkali	NPD (no performance determined)
Durability of water vapour resistance against ageing	Conforming

INSTALLATION

Apply Pandser® Top with stainless steel staples (or galvanized nails with a wide head) on the warm side of the roof or facade constructions on the underlying construction (with the logo legible from the inside). An overlap of 100 mm must be maintained for the horizontal and vertical overlaps. All overlaps, fixings and openings must be adhered airtight using our corresponding Pandser® Toptape. For joining and (wall) connections we recommend our Pandser® Butyltape.

RELATED PRODUCTS

Productname	Dimensions	Article number	EAN-code
Pandser® Toptape 0,06 x 25 M transparent	0,06 x 25 meters	VPM10300-9060	8713331014531
Pandser® Butyltape 0,02 x 15 M double sided	0,06 x 25 meters	VPM10300-9040	8713331028842