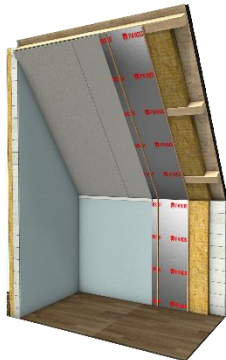

**PANDSER® TOP ALU**

Construction membrane  
for installation on  
the warm side.

**GENERAL**

Pandser® Top Alu is a vapor barrier and airtight multi-layer foil of pure heat-reflecting aluminum, which has an LDPE coating on both sides and is reinforced with an HDPE reinforcement mesh. Pandser® Top Alu complies with the European standard EN 13984.

Pandser® Top Alu is leverbaar in de volgende uitvoeringen:

Dimensions	Article number	EAN-code
1,50 x 25 meters	DWF10150-0029	8713331013503
1,50 x 50 meters	DWF10150-0030	8713331351124

**APPLICATION**

Pandser® Top Alu is used as a vapor-barrier on the warm side in pitched or flat roof constructions, as well as in facades. This foil is also pre-eminently suitable for use under floors in which a heat-resistance-increasing foil is to be used. Due to the coating of the aluminum, this foil is also resistant to anhydrite and this foil can be used as a moisture barrier and as a separation layer on the sand bed under screeds. Thanks to its vapor-barrier property, this film can also be used for constructions that belong to climate class 4, such as saunas, bathrooms, swimming pools, nurseries or other damp areas. Naturally, this foil can also be used to protect the construction against moisture for constructions that belong to climate class 2 and 3, such as living rooms, offices, etc.. This foil is resistant to large mechanical loads, such as during transport of prefabricated elements.

**PRODUCTPROPERTIES**

Roof



Foundation



Facade



Hard surface



Soft surface



Waterproof



Vapour barrier

Essential characteristics	
Mass per unit area	150 gr/m <sup>2</sup>
Reaction to fire	E
Water tightness	Conforming
Water vapour transmission properties (Sd)	600 [m] (-200/+300)
Determination of resistance to impact	NPD (no performance determined)
Joint strength	NPD (no performance determined)
Maximum tensile force – MD/CMD	>250 / >230 [N/50mm]
Resistance to tearing – MD/CMD	>150 / >150 [N]
Resistance to alkali	NPD (no performance determined)
Durability of water vapour resistance against ageing	Conforming

## INSTALLATION

Apply Pandser® Top Alu with stainless steel staples (or galvanized nails with wide heads) on the warm side of the roof, facade and floor constructions. Pandser® Top Alu can be attached directly on the inside, against the insulation material, to the purlins or tracks of the roof construction or to the post and framework of the (timber frame) facade construction with these staples or compression laths. When the aluminum side faces inward and is adjacent to an air cavity, the insulation value is improved by reflecting infrared heat radiation. An overlap of 100 mm should be maintained for the horizontal and vertical overlaps. All overlaps, fixings and recesses must be finished airtight using our accompanying Pandser® Alutape. Stick lead-throughs and connections with our Pandser® Butyltape.

## RELATED PRODUCTS

Productname	Dimensions	Article number	EAN-code
Pandser® Alutape 0,05 x 50 M	0,05 x 50 meters	VPM10300-9050	8713331009032
Pandser® Butyltape 0,02 x 15 M double sided	0,06 x 25 meters	VPM10300-9040	8713331028842